

Table with columns for 'G.U.', 'UOU', 'OP', 'VIVB', 'OUT UOU', 'BOUT', 'COUT', 'FOUT', 'G.U.'. It contains numerical data for various roof types and materials.

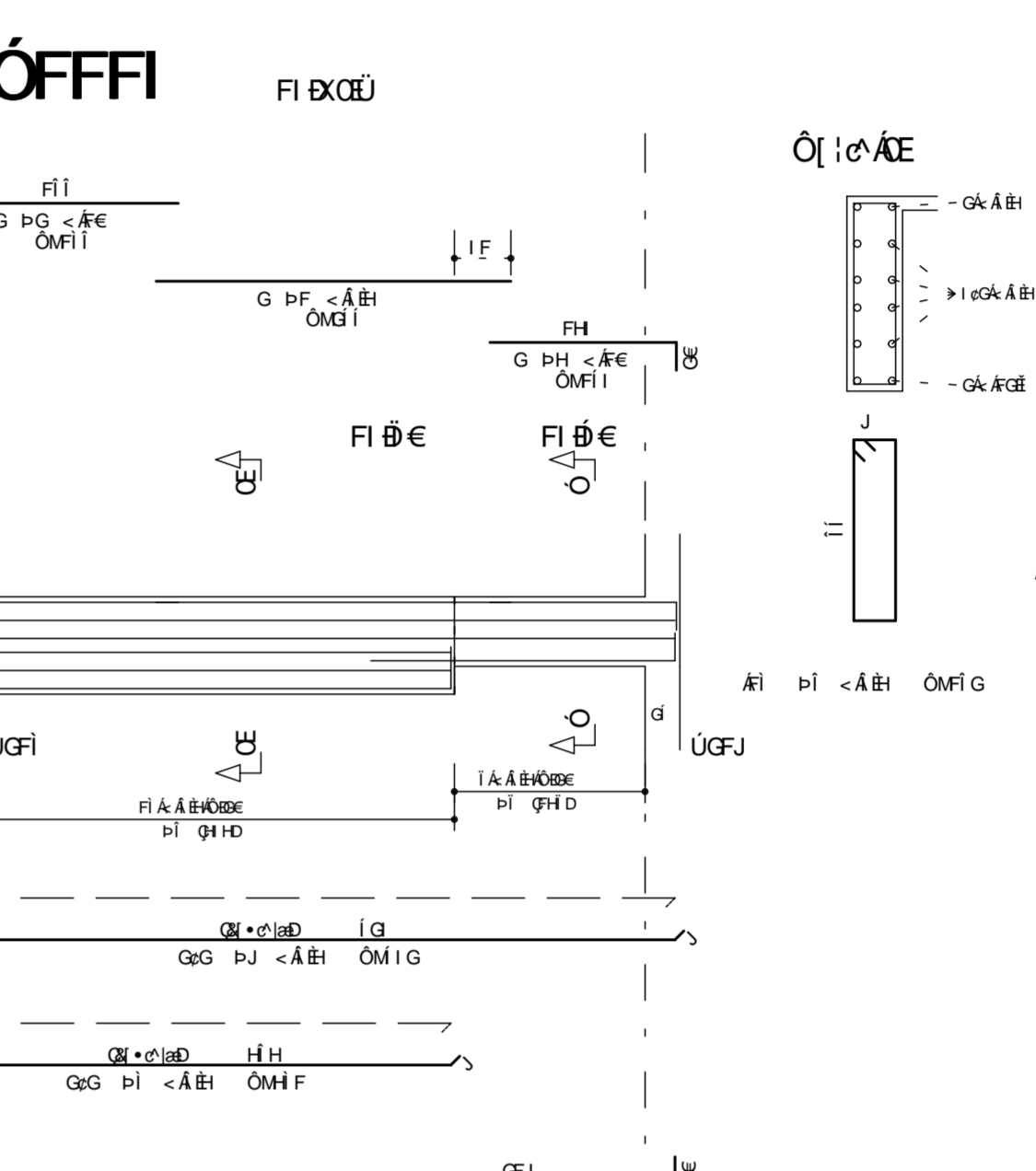
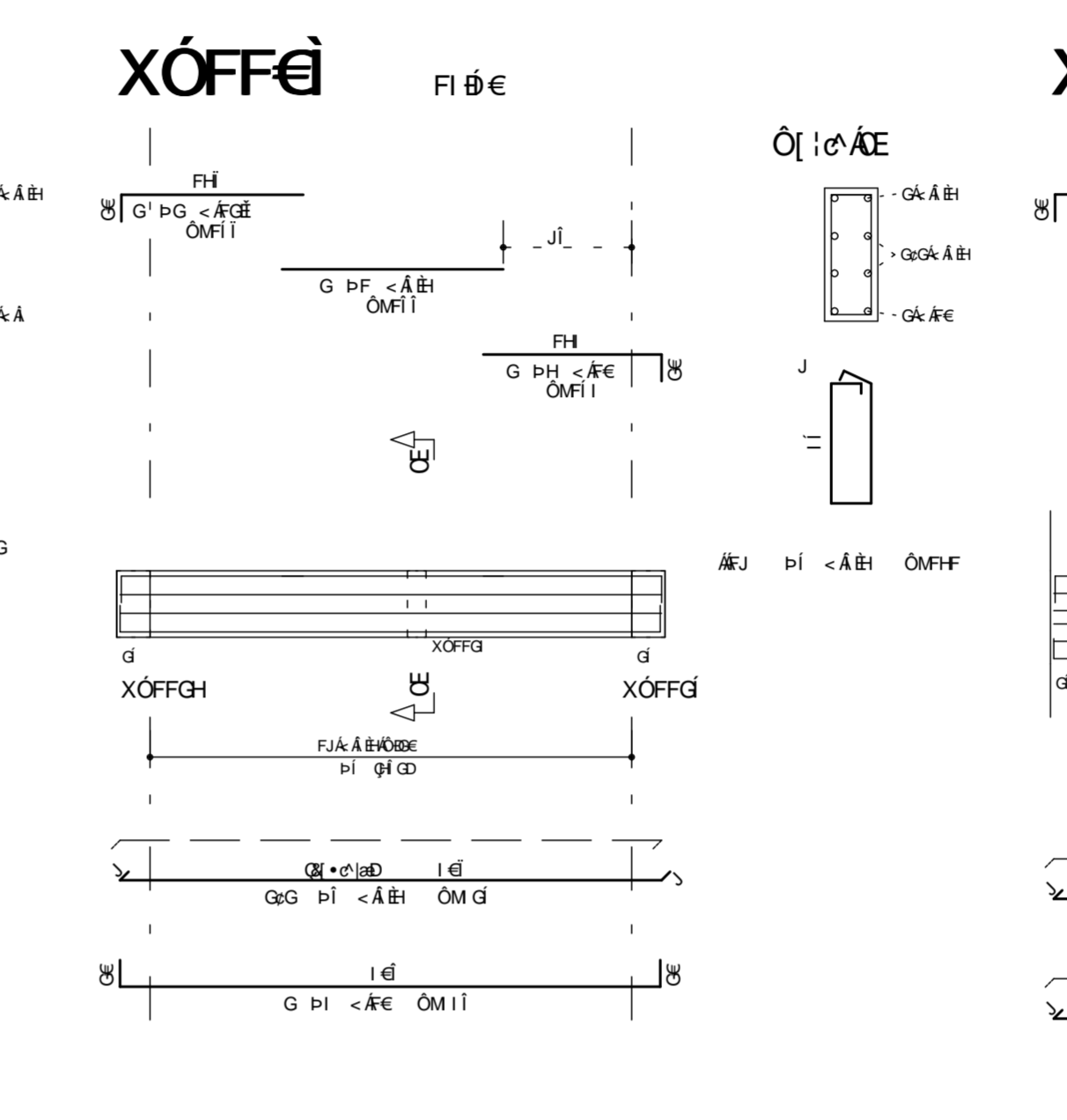
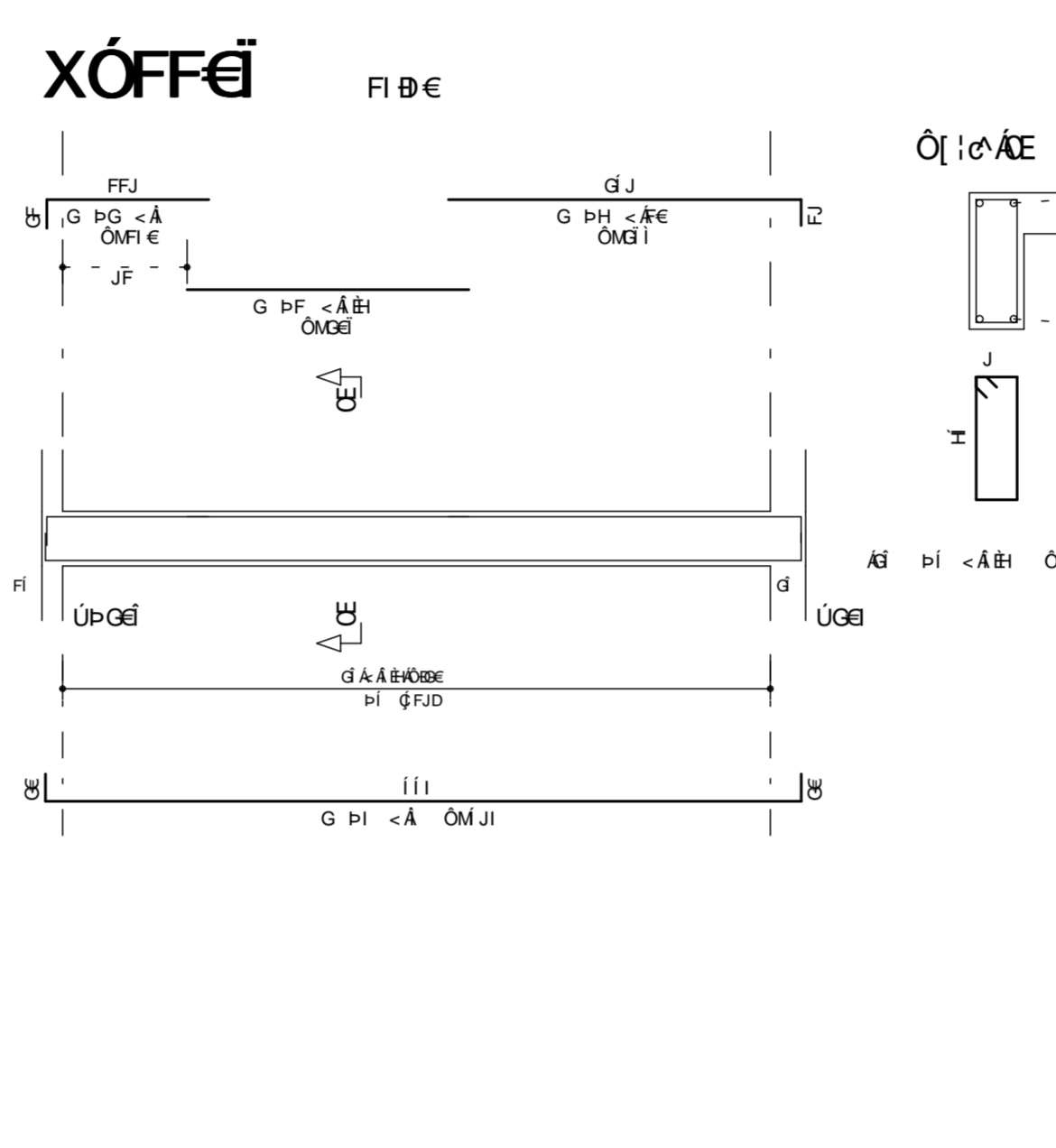
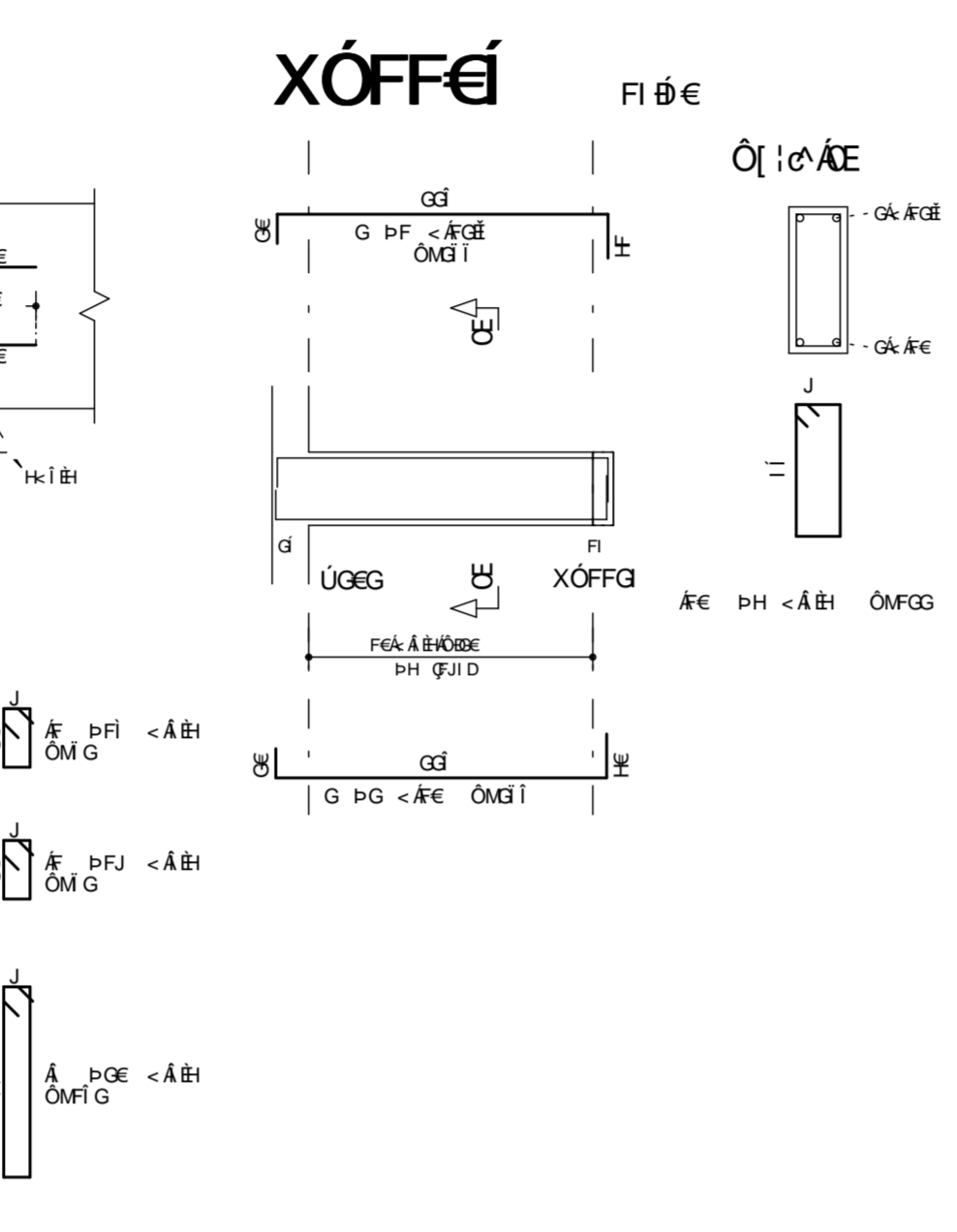
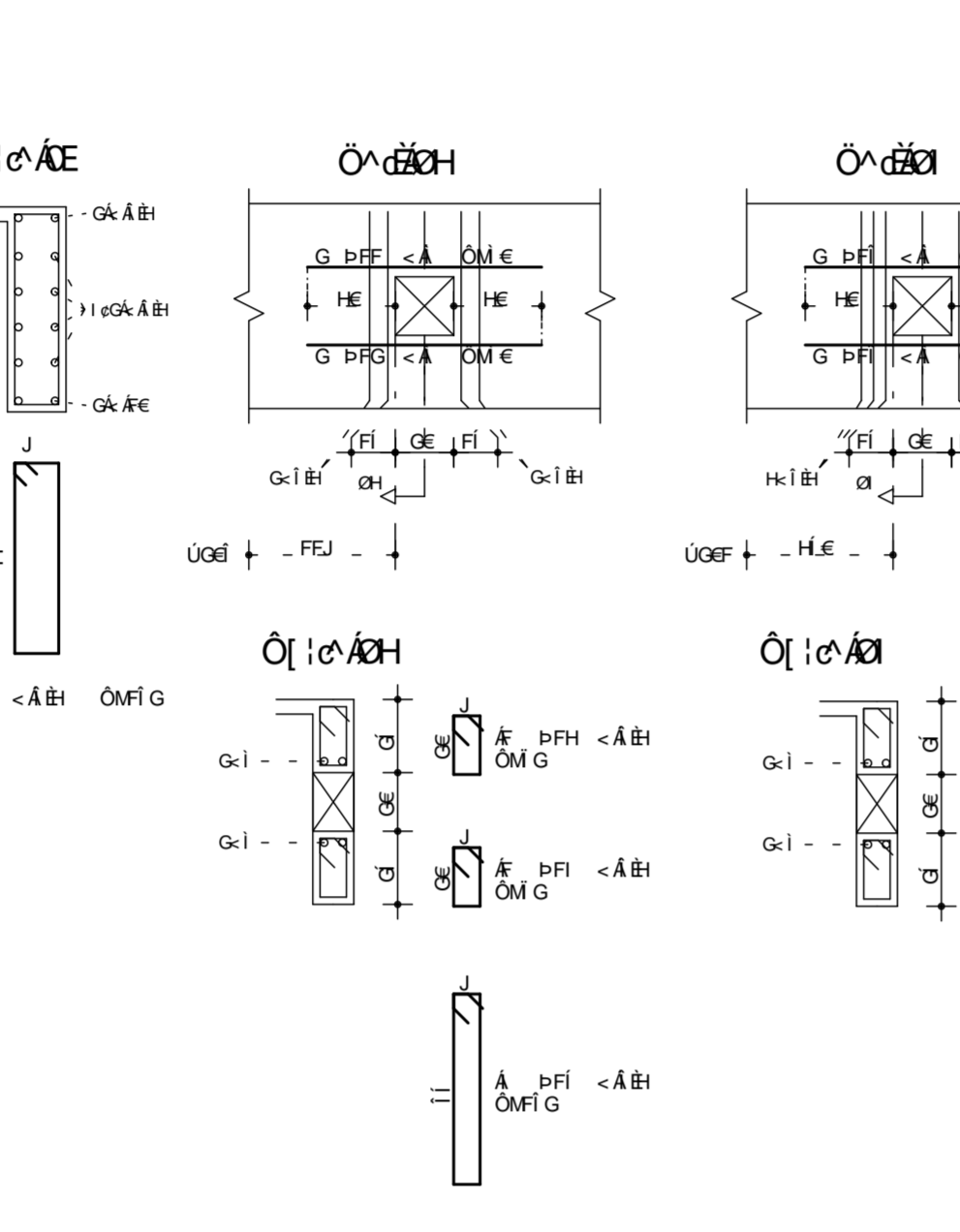
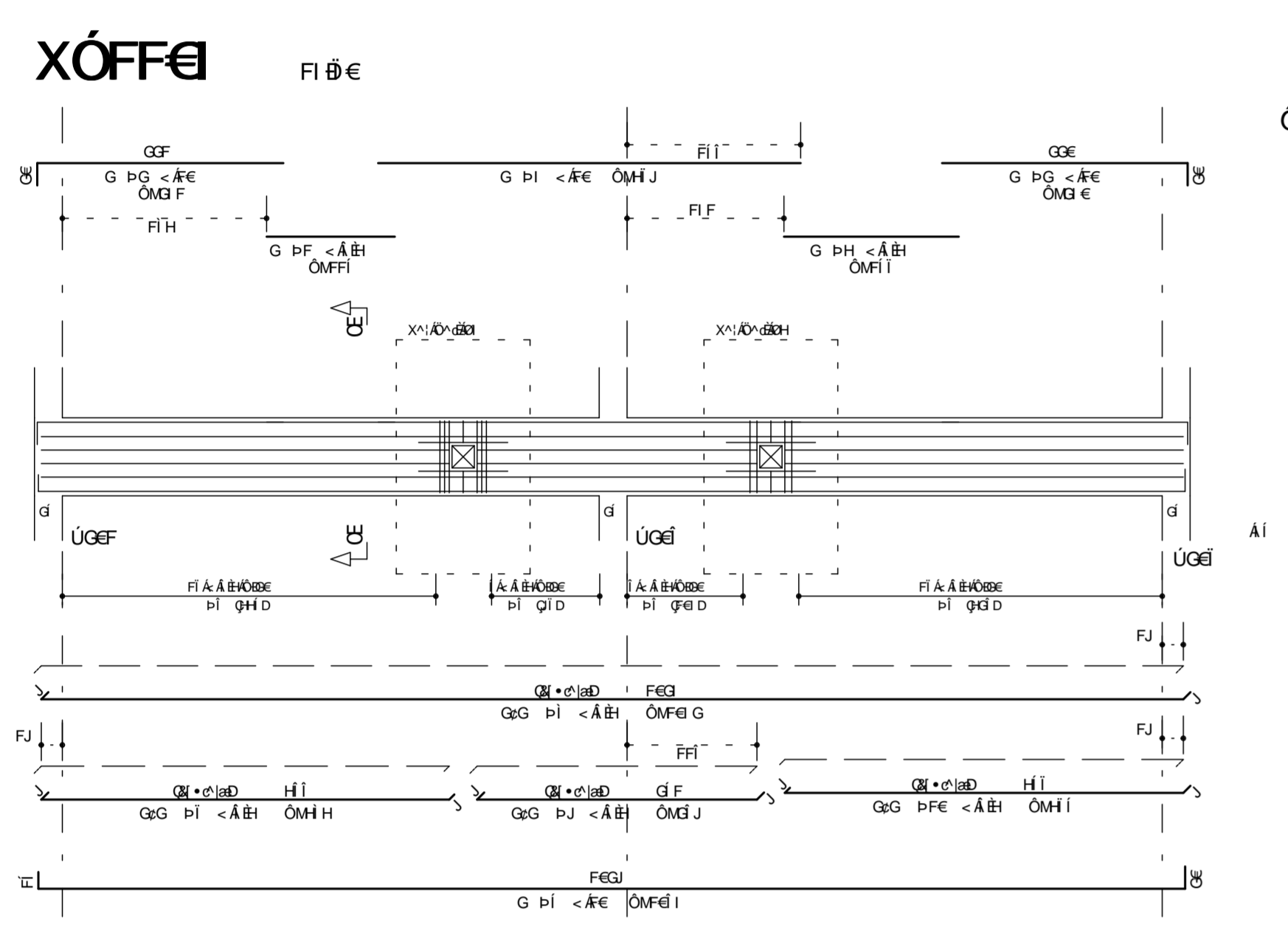

Table with columns for 'G.U.', 'UOU', 'OP', 'VIVB', 'OUT UOU', 'BOUT', 'COUT', 'FOUT', 'G.U.'. It contains numerical data for various roof types and materials.

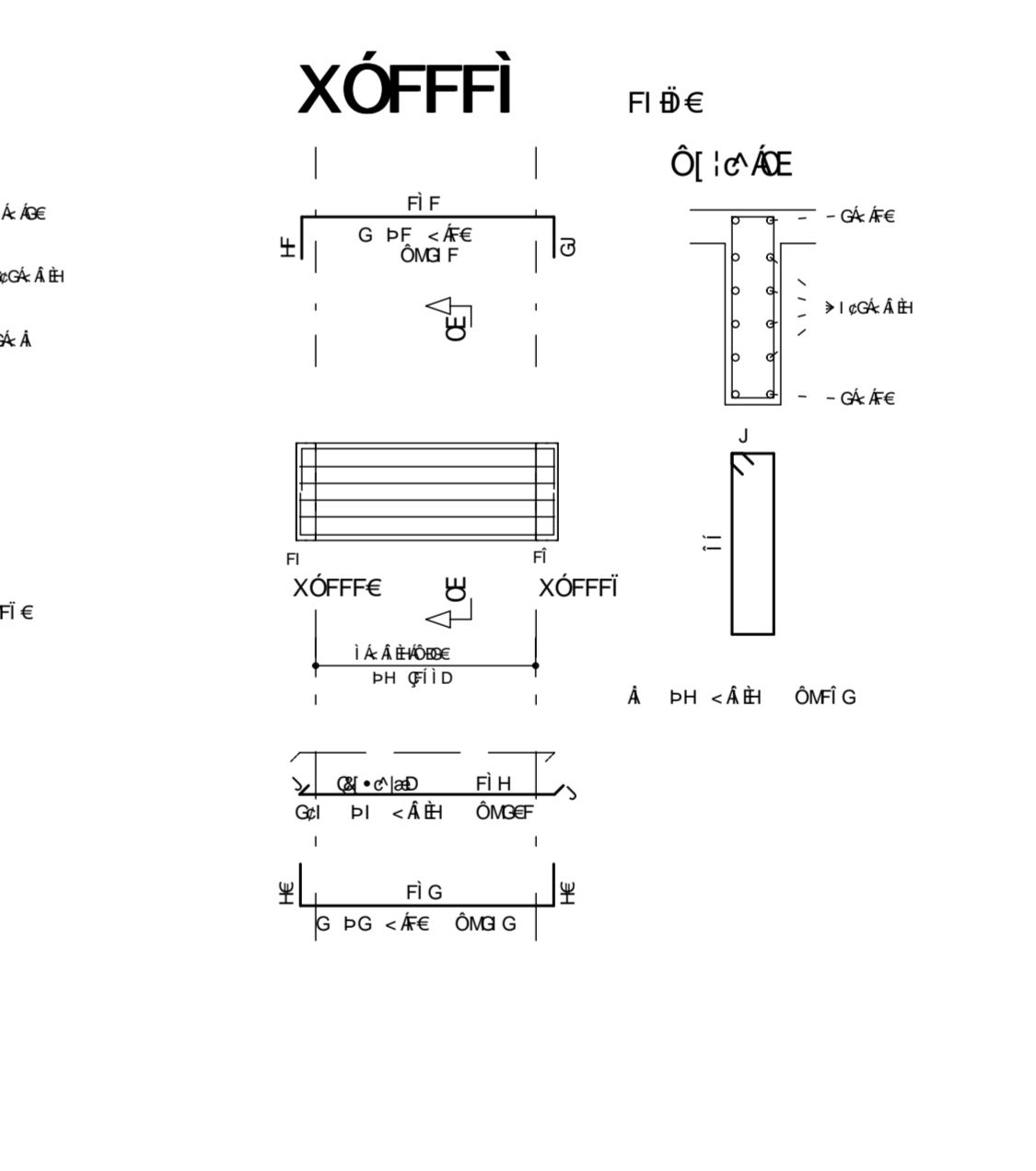
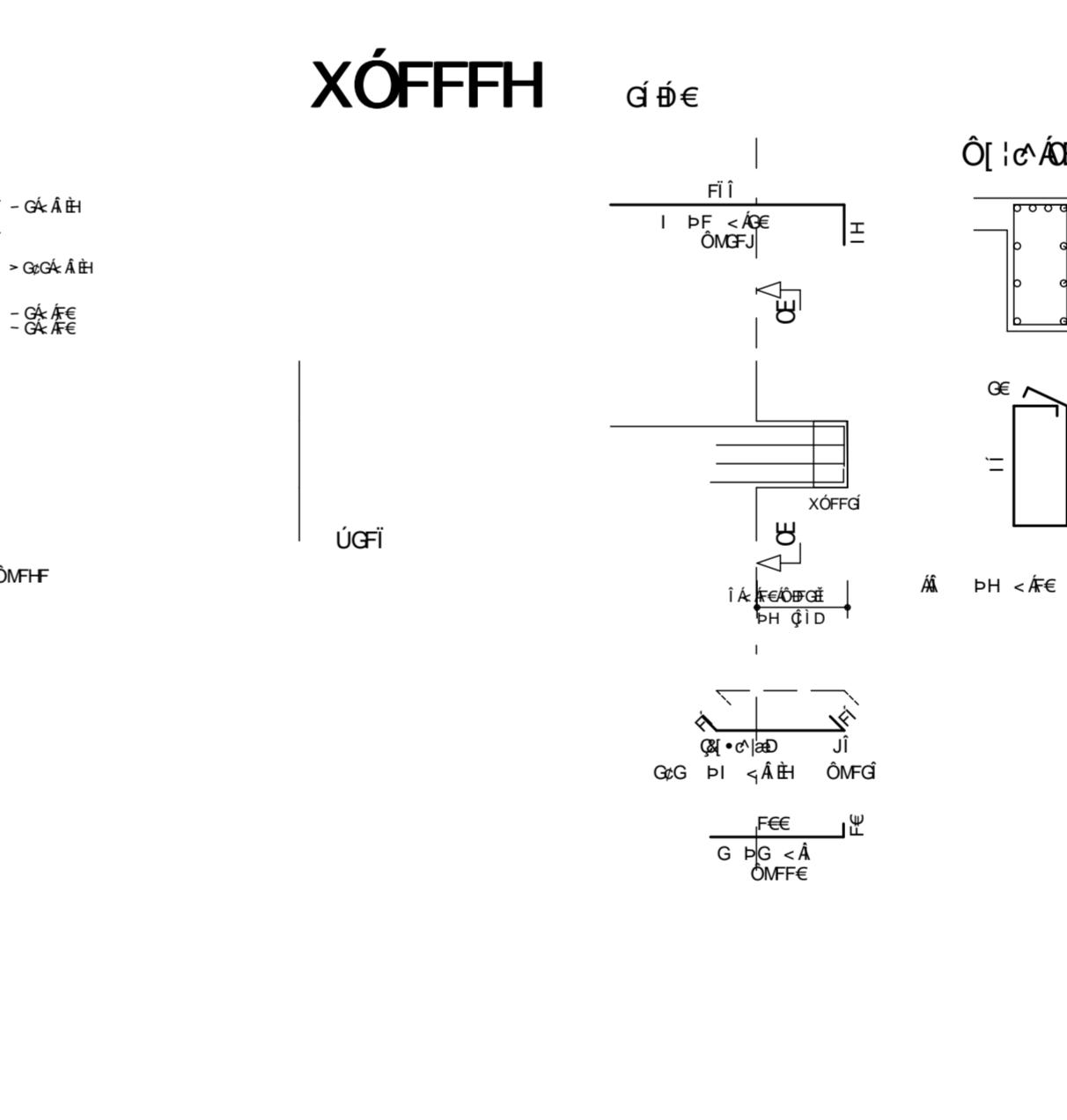
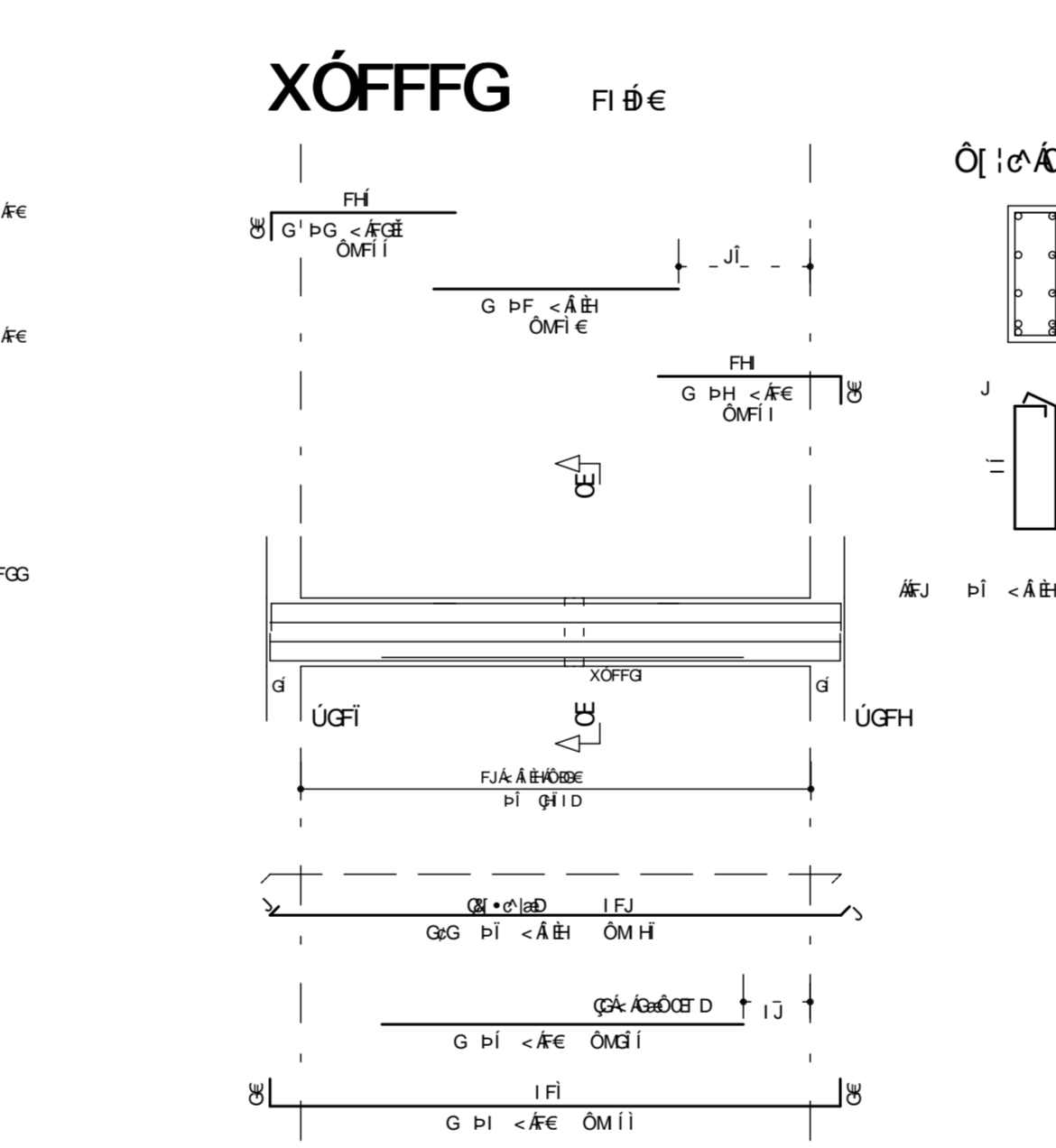
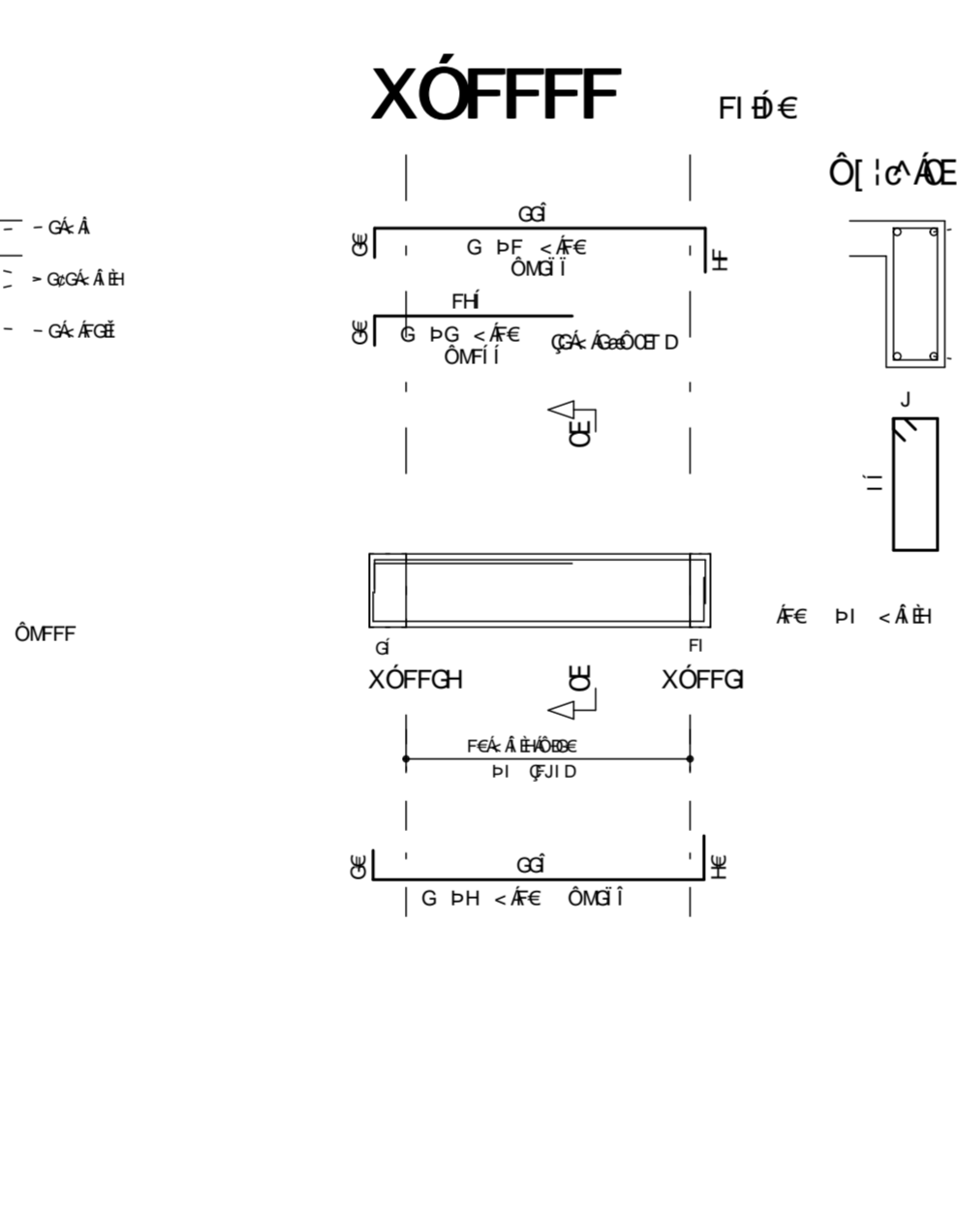
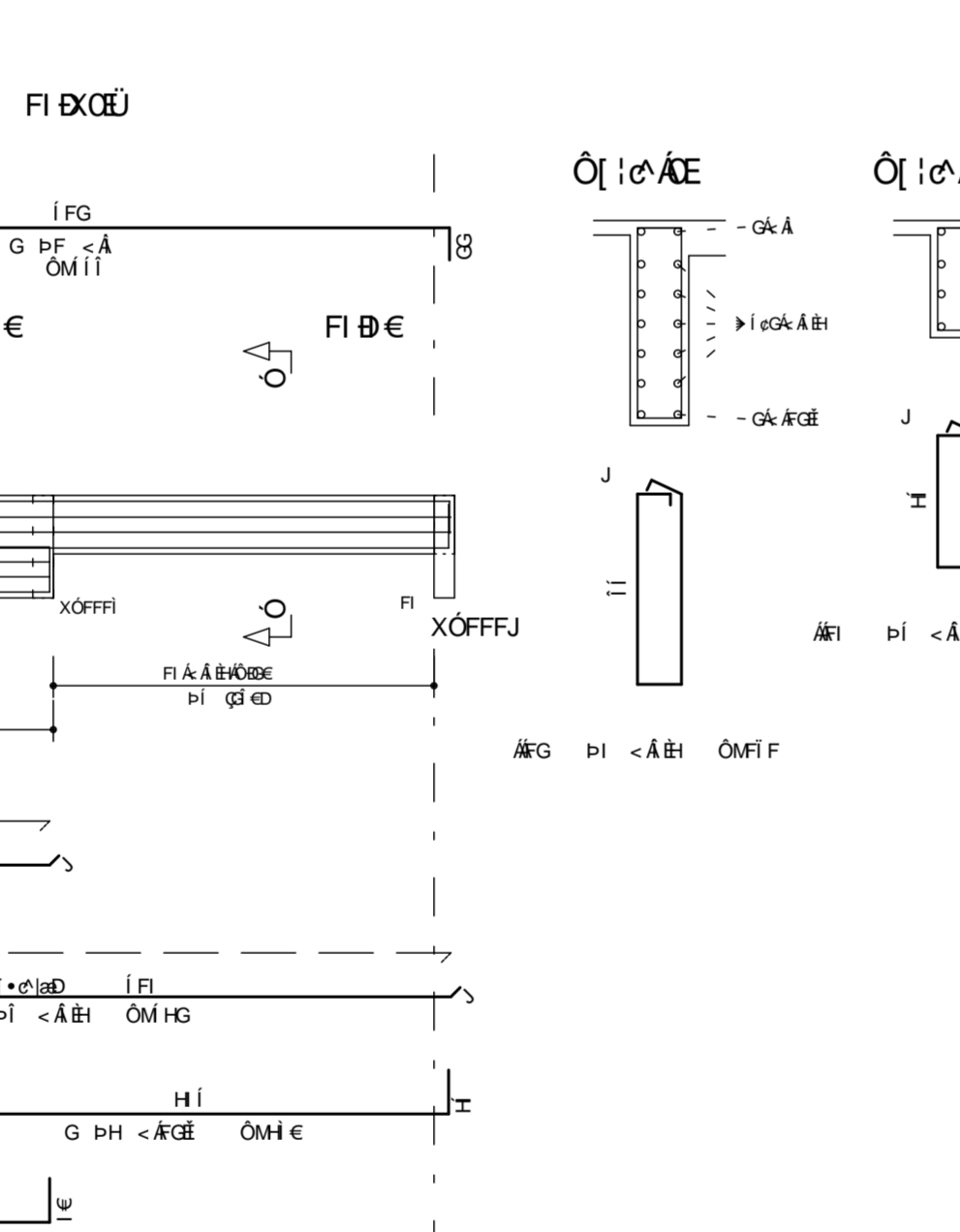
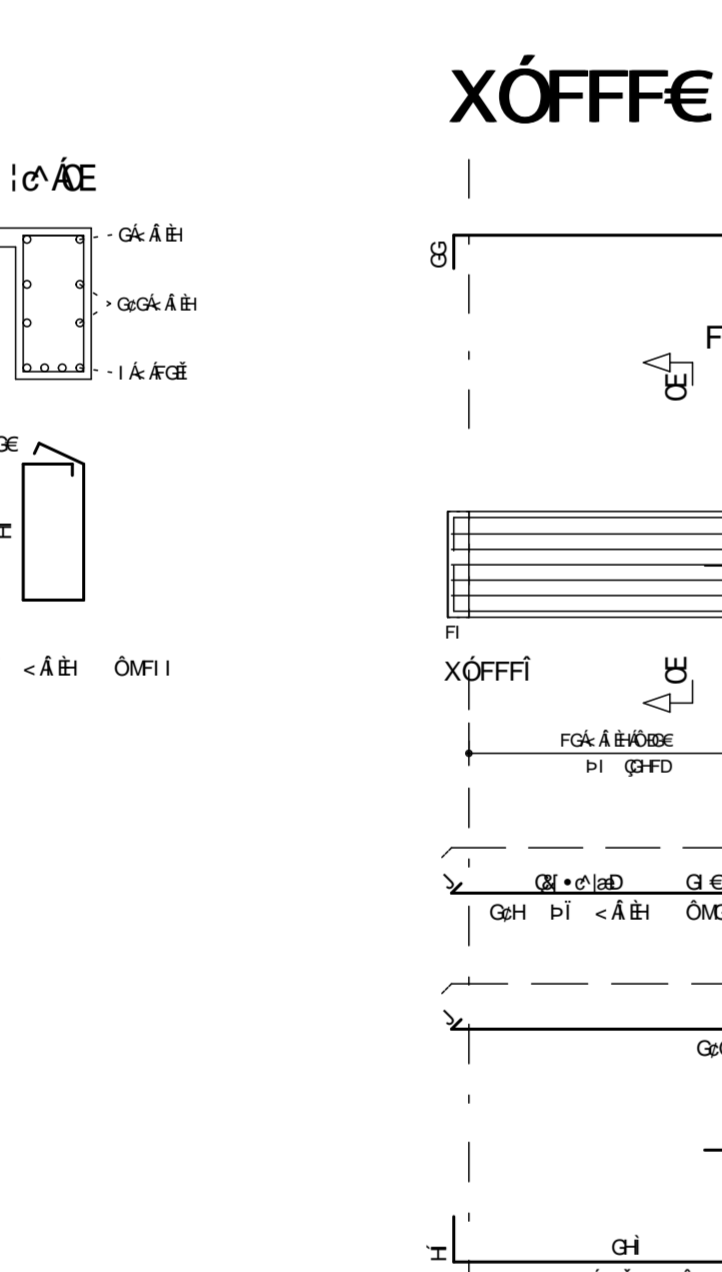
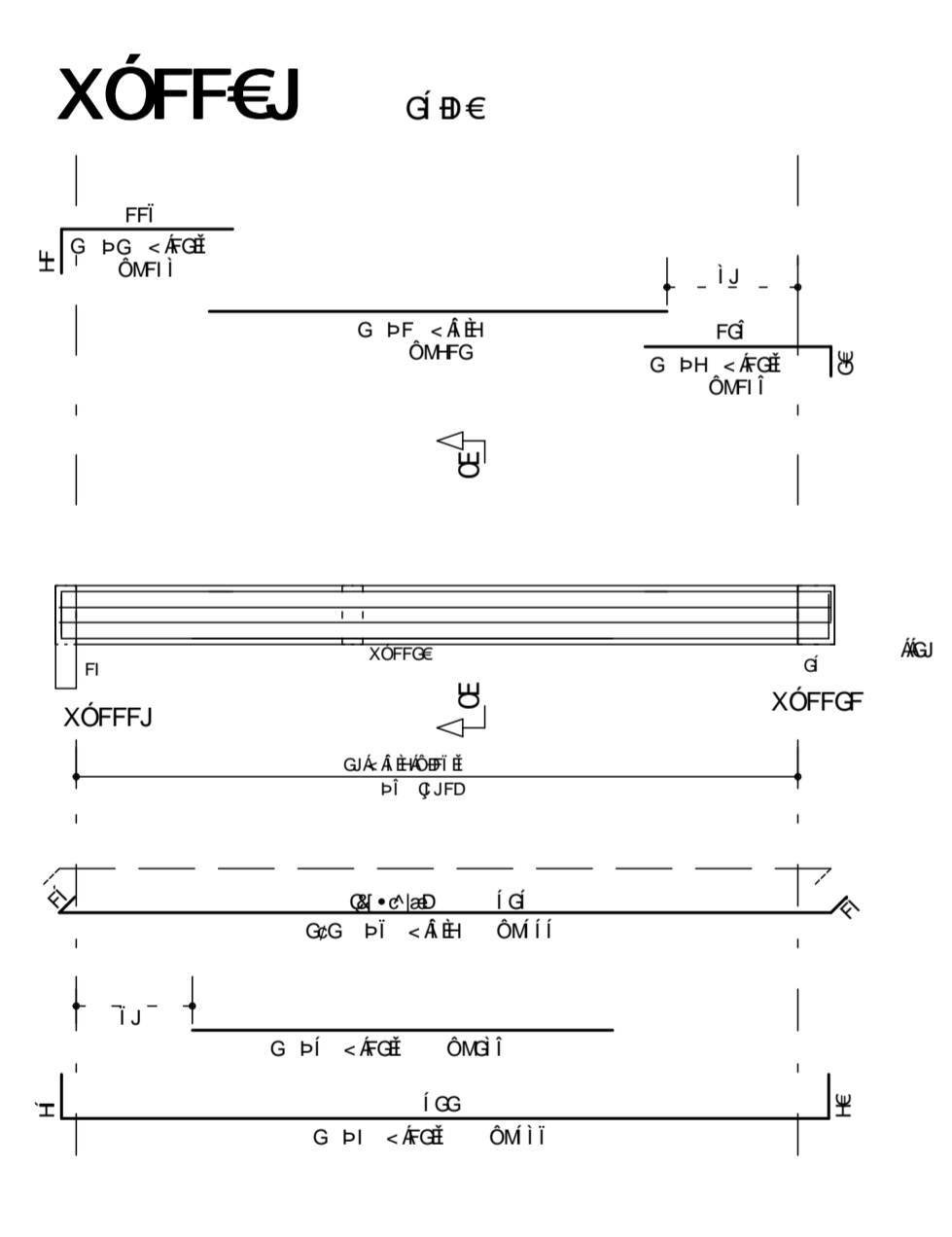
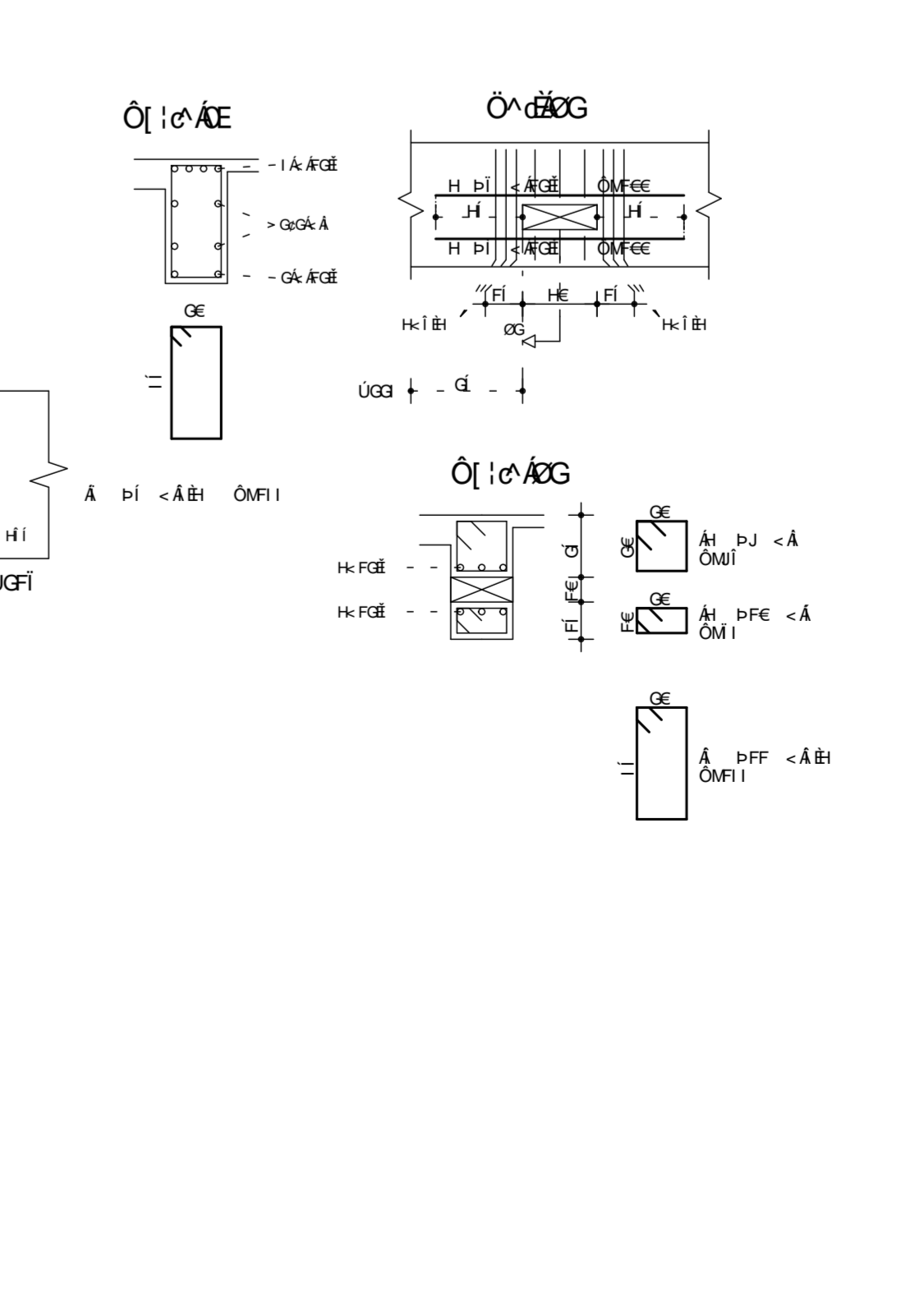
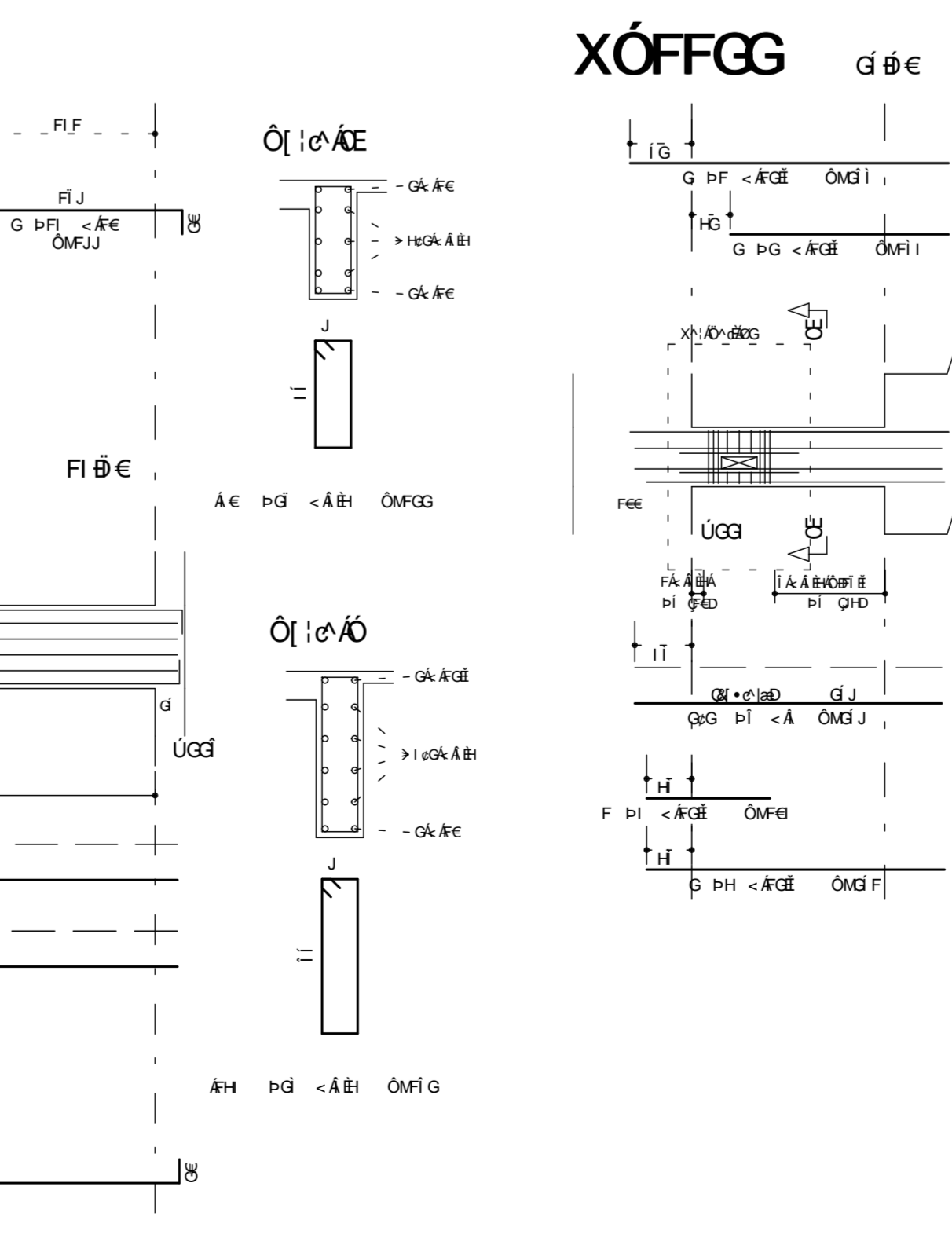
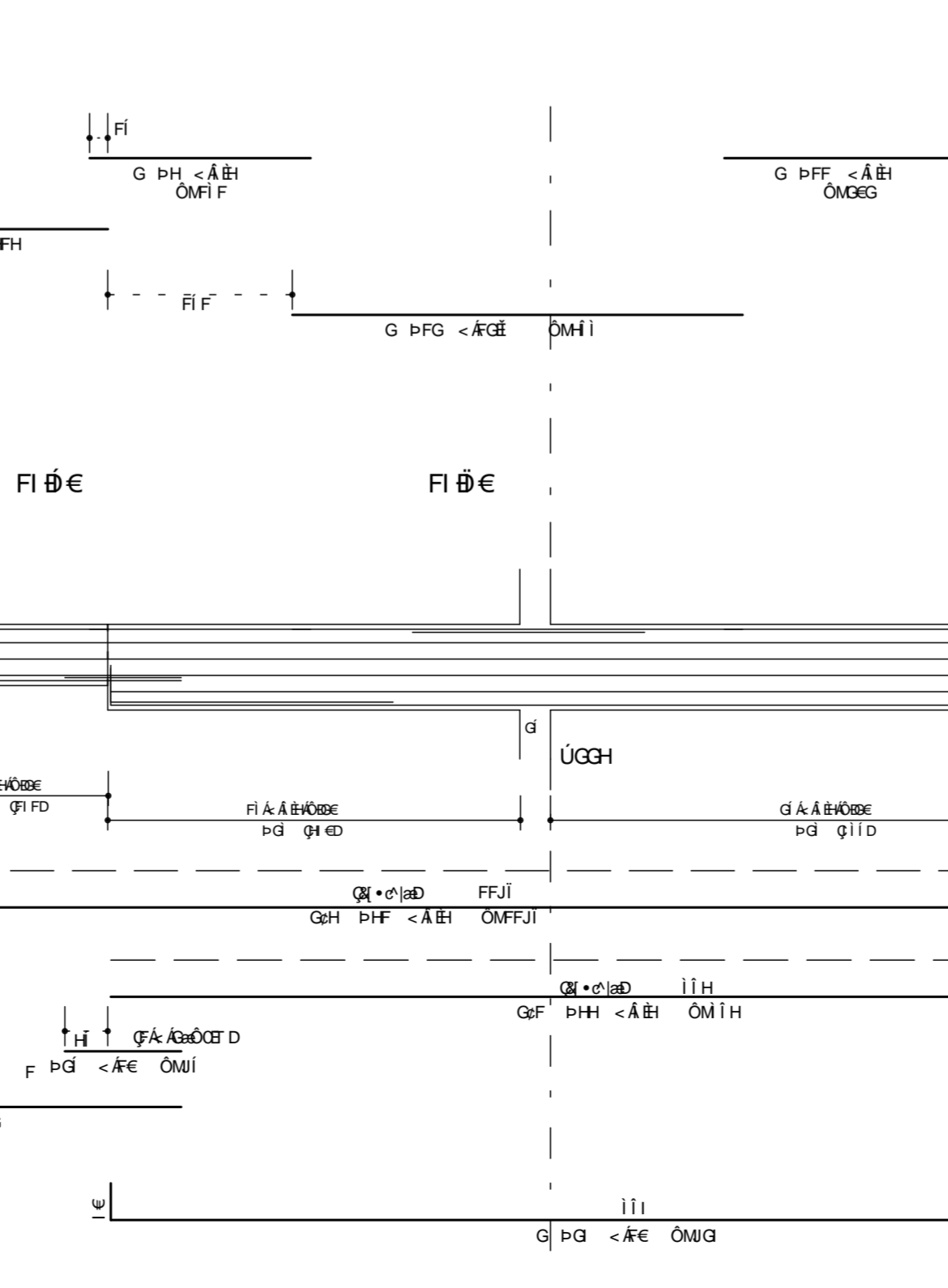
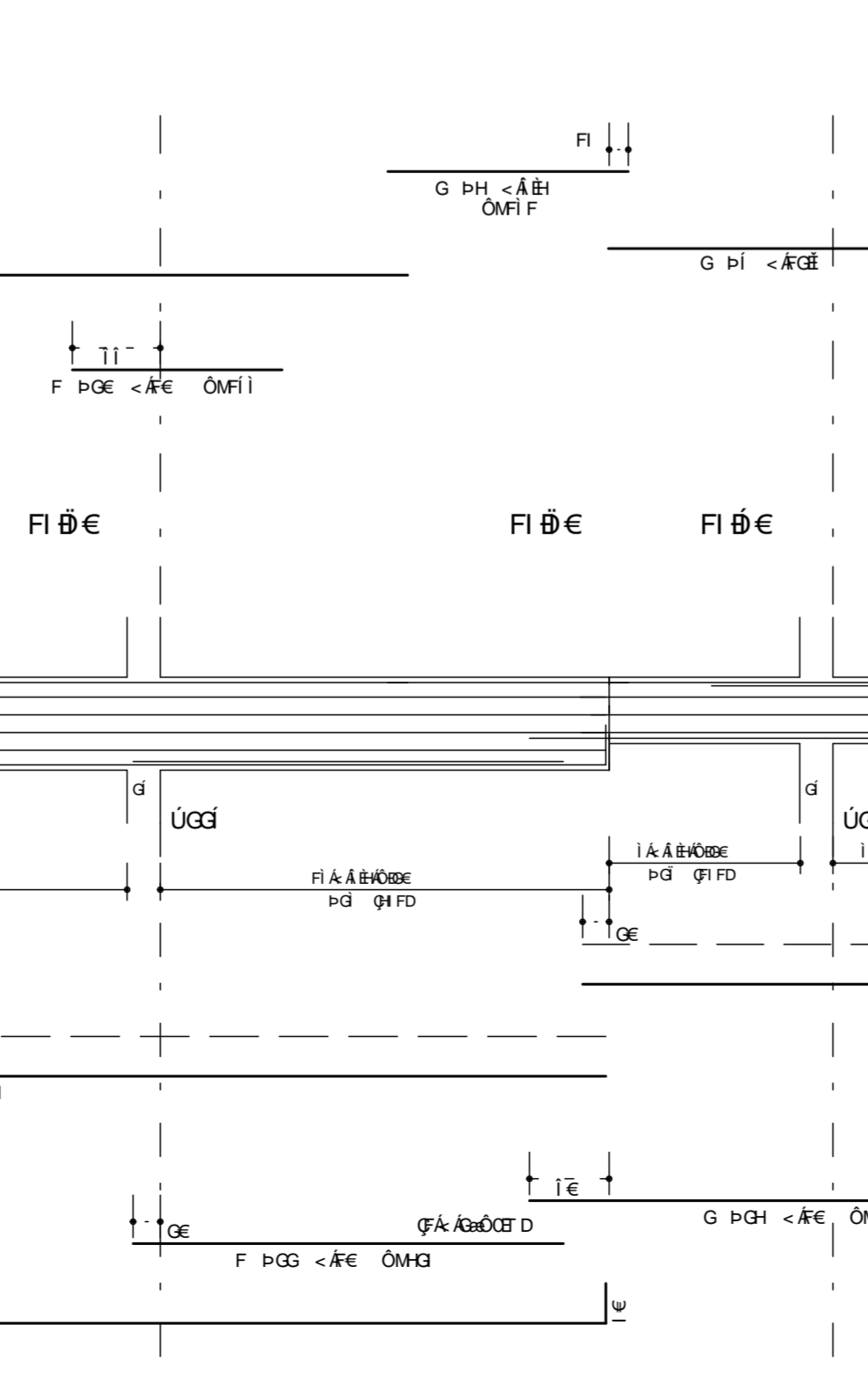
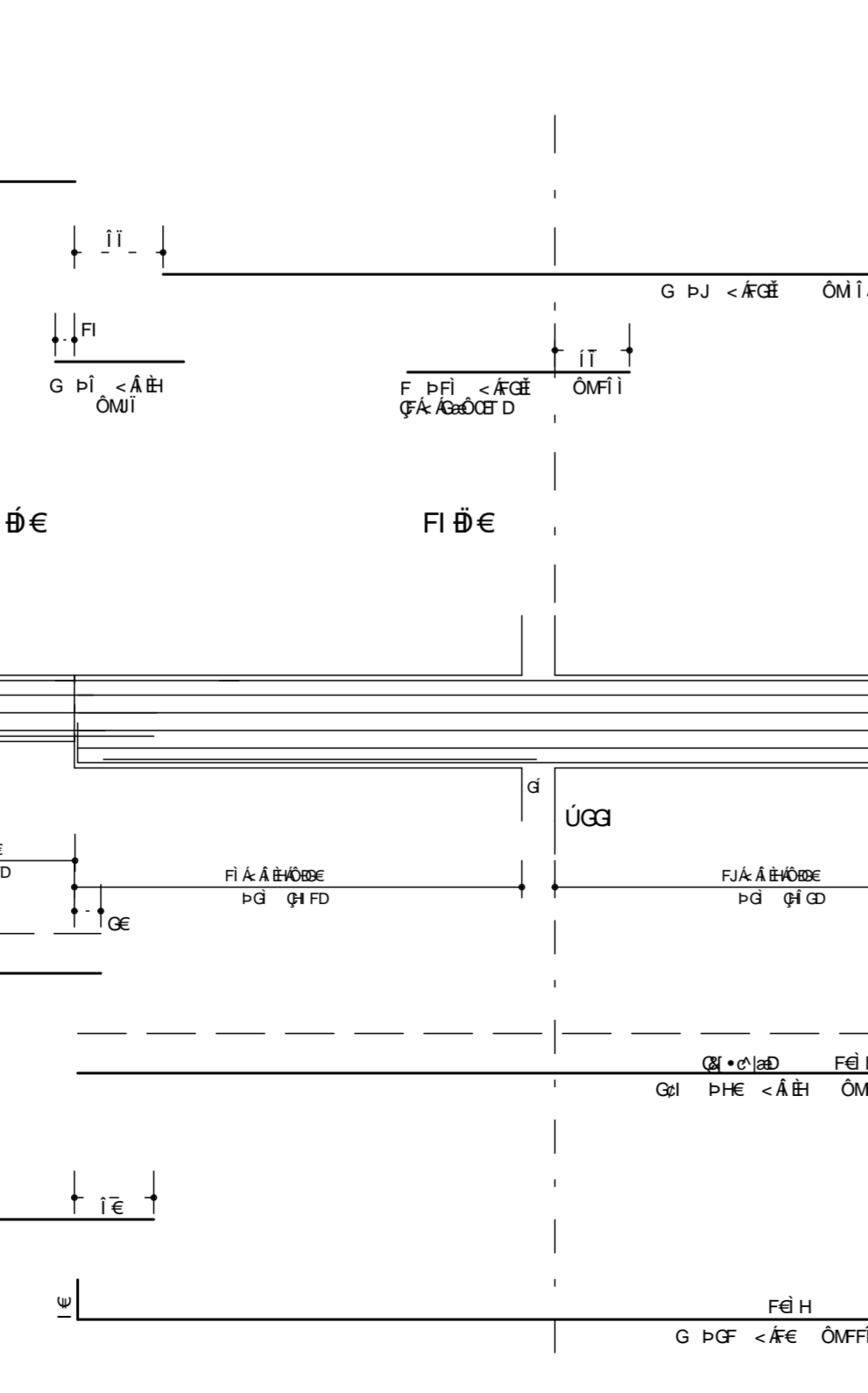
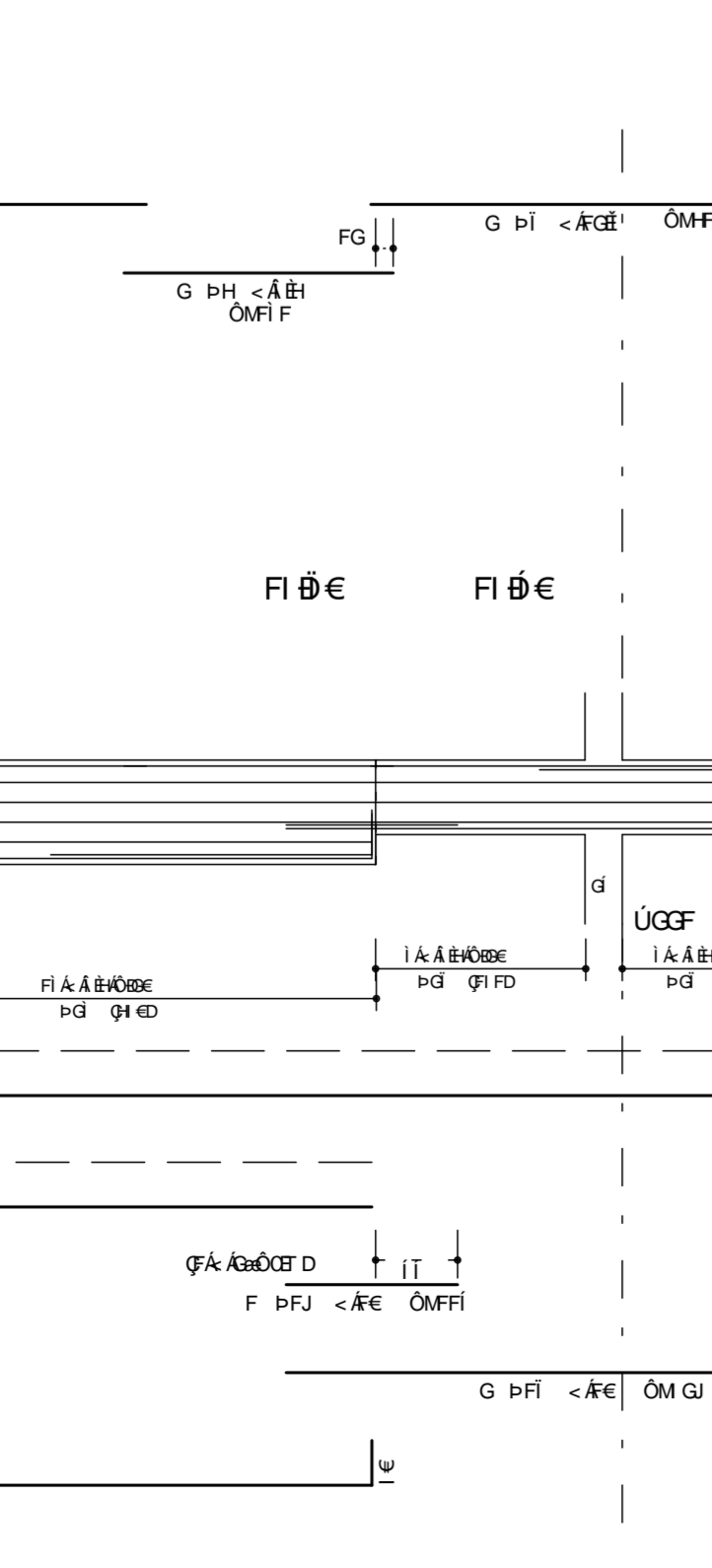
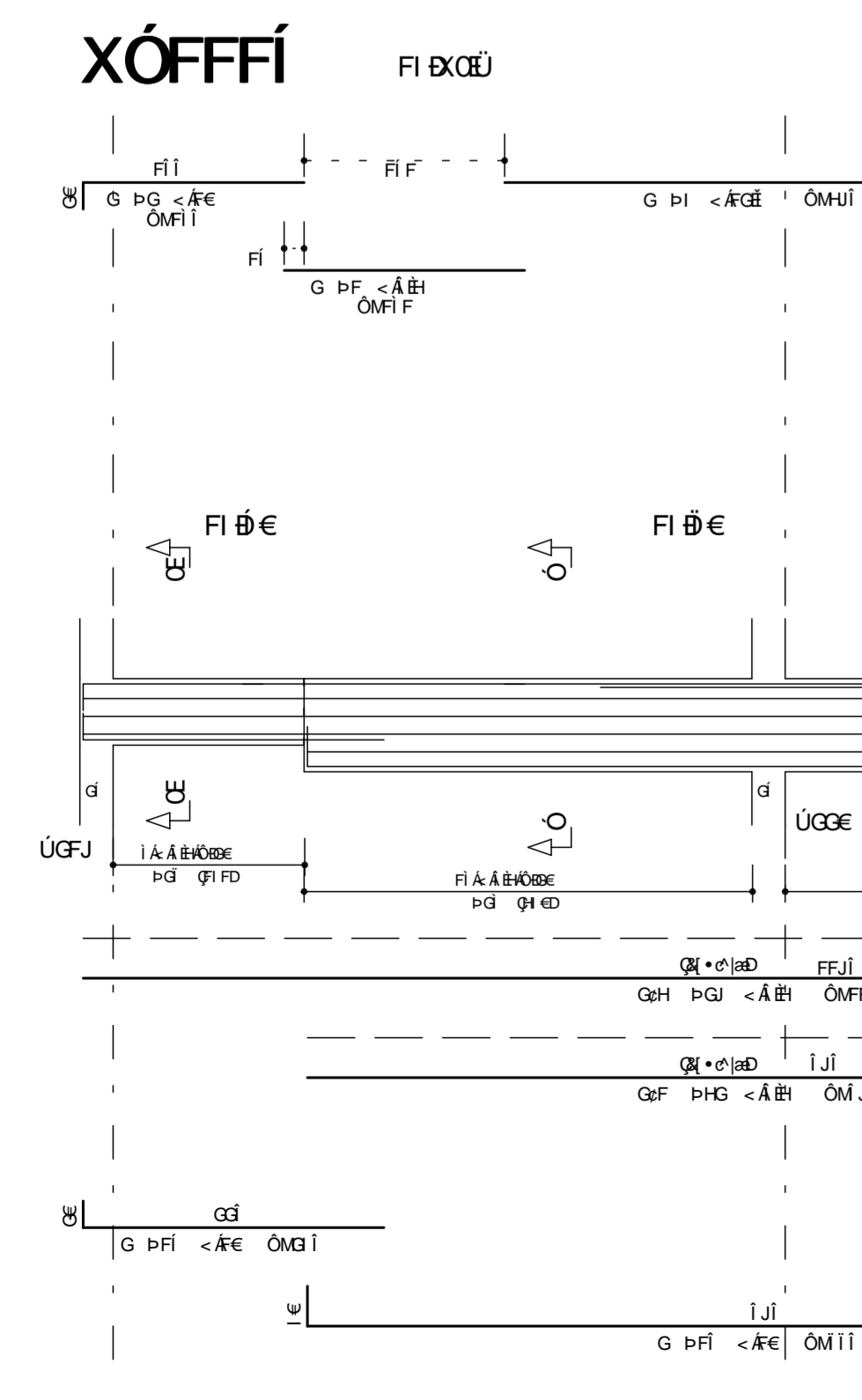

Table with columns for 'G.U.', 'UOU', 'OP', 'VIVB', 'OUT UOU', 'BOUT', 'COUT', 'FOUT', 'G.U.'. It contains numerical data for various roof types and materials.



Project information section including the title 'ΧΟΨΕΙ (FI BE)', client 'ΣΜ Η Τ', location 'ΟΔΟΣ Γ ΟΥΑΕ', and company 'Simetria Engenharia'. It also includes contact information and a signature.